

Four Student Examples of Testing Apparatuses and Procedure Write-Ups/Slides

Example 1

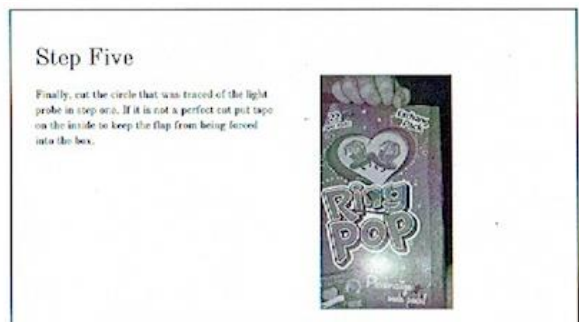

Example 2

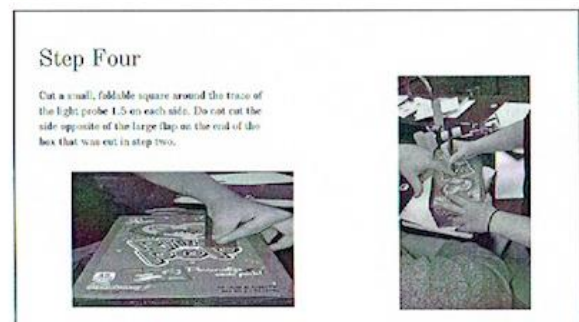
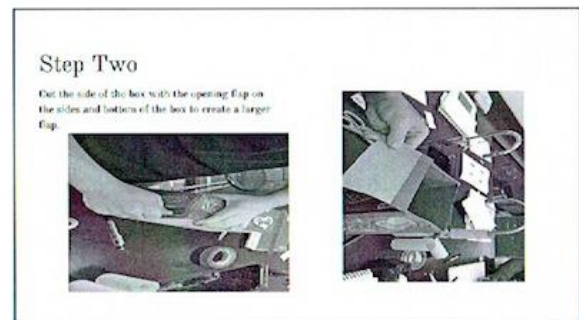
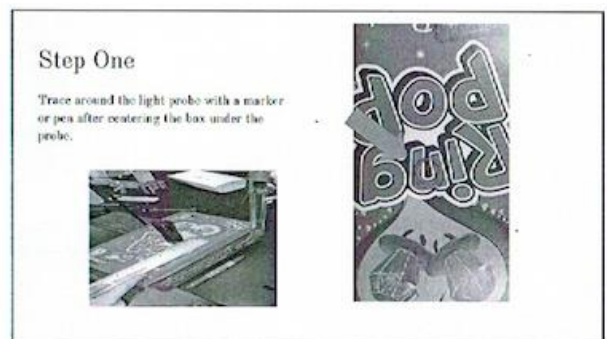
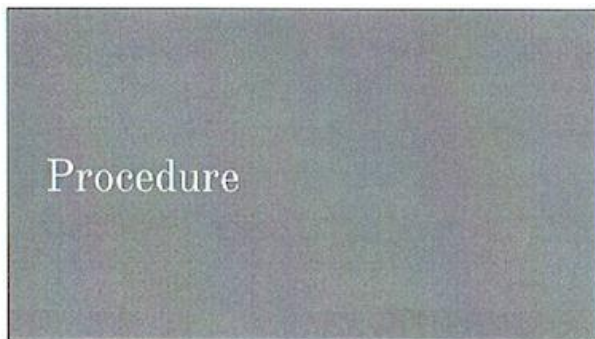
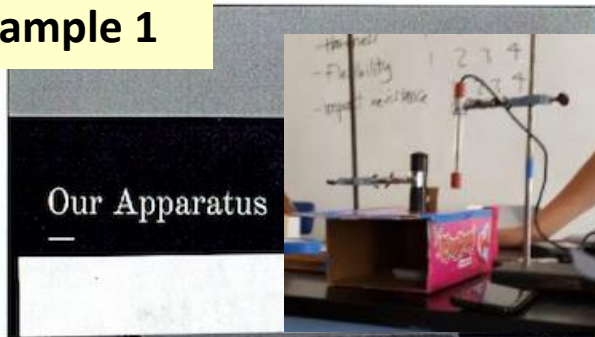
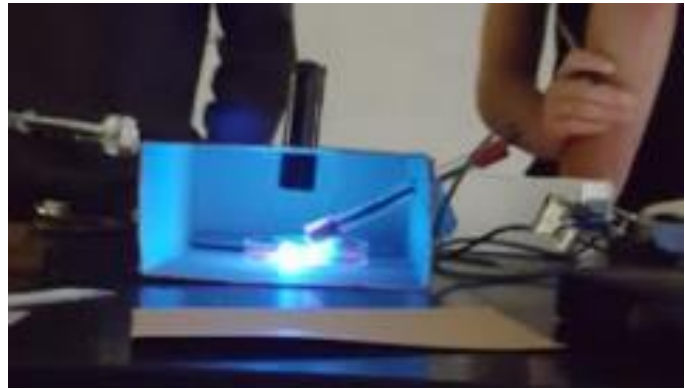

Our Apparatus

...

Materials

- Pencil
- Tape
- Ruler
- Petri dish
- Scissors
- 22.86 x 16.51 centimeters piece of cardboard
- 22 pouch Frozen gummy box (10% more free)
- Sample template

Here is a picture of the materials we gathered and used in the making of our apparatus.



Instructions

1. Cut flaps off gummy box
 2. Cut cardboard piece to dimensions of frozen box opening rectangle
 3. Measure out diameter for flashlight and light sensor
 4. Cut out holes for flashlight and light sensor
- *keep all extra cardboard pieces to cover up outside light coming into the apparatus while samples are being tested.

Example 3

OUR BIOPLASTIC APPARATUS



STEP ONE

We measured a Sour Patch Kids box, and it was 23cm long, 7.5cm high, and 18cm wide. We then cut a 15cm long and 5cm long cut in the middle of the side of the box.



STEP TWO

We cut two tissue paper roll size holes in the center of the box top with a centimeter space between the holes.



STEP THREE

We covered one hole on each of the two paper rolls with masking tape.



STEP FOUR

We taped the rolls in the holes that we previously cut in the box with masking tape inside the box with enough room for the petri dish to fit.



Example 4

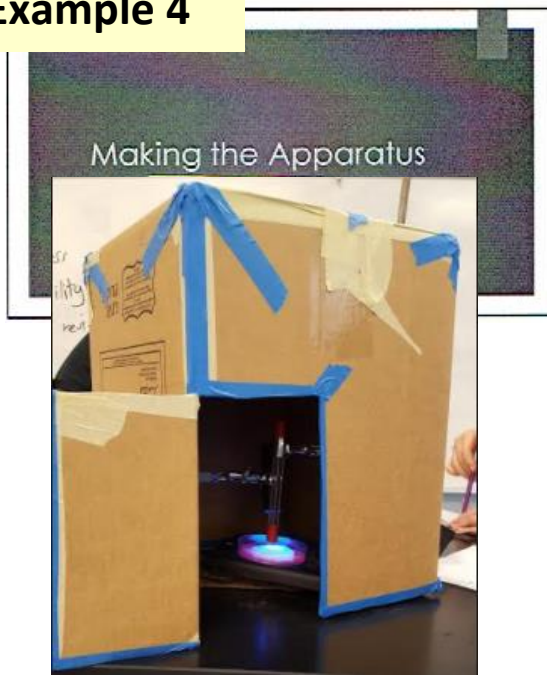

Step 3: Measure the Whole Box



Step 1: gather all materials needed

- Cardboard Box
- Masking Tape
- Scissors
- Tin Foil

Step 2: Cut of the Flaps



Step 4: Cut a Door on the box big enough to fit you hand



Step 5: Cut two small holes on the top of the box to fit the

Measure the length between the two holes, so the poles will fit through the box.

Length: 22 1/4 cm.



Step 6: Tape the cracks of the box and the door

Use masking tape to cover all of the cracks. You need to make sure that you can keep as much light as possible out.



Step 7: Add tinfoil inside of the box

Tape the tinfoil on the top and inside of the box. Make sure it cover the whole top of the box.

